

## **PUBLIC PATH DIVERSION ORDER**

**Town and Country Planning Act 1990, Section 257**

### **HORSHAM DISTRICT COUNCIL PUBLIC FOOTPATH No. 2360 (PART) PUBLIC PATH DIVERSION ORDER 2020**

This order is made by HORSHAM DISTRICT COUNCIL under section 257 of the Town and Country Planning Act 1990 because it is satisfied that it is necessary to DIVERT the footpath to which this order relates in order to enable development to be carried out in accordance with planning permission applied for but not yet granted under planning application reference DC/20/1005 under Part III of the Town and Country Planning Act 1990, namely the demolition of an existing dwelling and the erection of a replacement two-storey dwelling, at Palacelands Farm, Hooklands Lane, Coolham, West Sussex.

#### **BY THIS ORDER:**

1. The footpath marked by a continuous black and purple line on the attached Order Map ("the Order Map") and described in Part 1 of the Schedule to this Order ("the Schedule") shall be diverted as provided below.
2. There shall be created to the reasonable satisfaction of Horsham District Council and the West Sussex County Council, an alternative footpath for use as a replacement for the said footpath as provided in Part II of the Schedule and shown by a broken black line on the Order Map.
3. The diversion of the footpath shall have effect on the date on which Horsham District Council shall certify that the terms of Article 2 above have been complied with.
4. The following works shall be carried out in relation to the footpath described in Part II of the Schedule, that is to say :
  - (a) The alternative footpath shall be a minimum useable width of 2 metres.
  - (b) The alternative footpath shall be free from all obstructions and must not include any gates, stiles posts or other structures unless authorised by West Sussex County Council following an application for consent.
  - (c) If the existing gates are to be retained for livestock control, consent must be obtained from the Director of Highways and Transport, West Sussex County Council and the gates brought up to an approved standard with a minimum width of 1.2 metres (4 feet).
  - (d) Any barbed wire in fencing adjacent to the path must be positioned on the side of the posts away from the path.
  - (e) The new route shall be waymarked by West Sussex County Council and the cost will be recharged to the applicant.
5. Roger and Lucy Sheridan will pay the cost of carrying out the above-mentioned works.
6. Where immediately before the date on which the footpath is stopped up and diverted, there is apparatus under, in, on, along or across that footpath belonging to Statutory Undertakers for the purpose of carrying on their undertaking, the Undertakers shall continue to have the same rights in respect of the apparatus as they then had.

7. This Order may be cited as the Horsham District Council Public Footpath No. 2360 (Part) Public Path Diversion Order 2020.

## SCHEDULE 1

### PART 1

#### Description of Existing Path or Way which is to be Stopped Up

Part of public footpath No. 2360 commencing at point A on the Order Map (Grid ref: N 120098 E 512473 and extending for approximately 478 m as shown in a south westerly direction until point C on the Order Map (Grid ref: N 119845 E 512206, as shown by a continuous black line on the Order Map.

### PART 2

#### Description of the Alternative Footpath as Diverted

The new route of the footpath having a minimum width of 2 metres throughout commences at point A on the Order Map (Grid ref: N 120098 E512473) and drops down in a southerly direction for approximately 300 metres to point B (Grid ref: N 119828 E 512375) turning westwards for approximately 170 metres, to point C (Grid ref: N 119845 E 512206), as shown by a broken black line on the Order Map.

Dated this <sup>th</sup> 17 day of December 2020

17 227

THE COMMON SEAL of  
HORSHAM DISTRICT COUNCIL

Was hereto affixed

in the presence of:-

S. L. Green

Head of Legal and Democratic Services



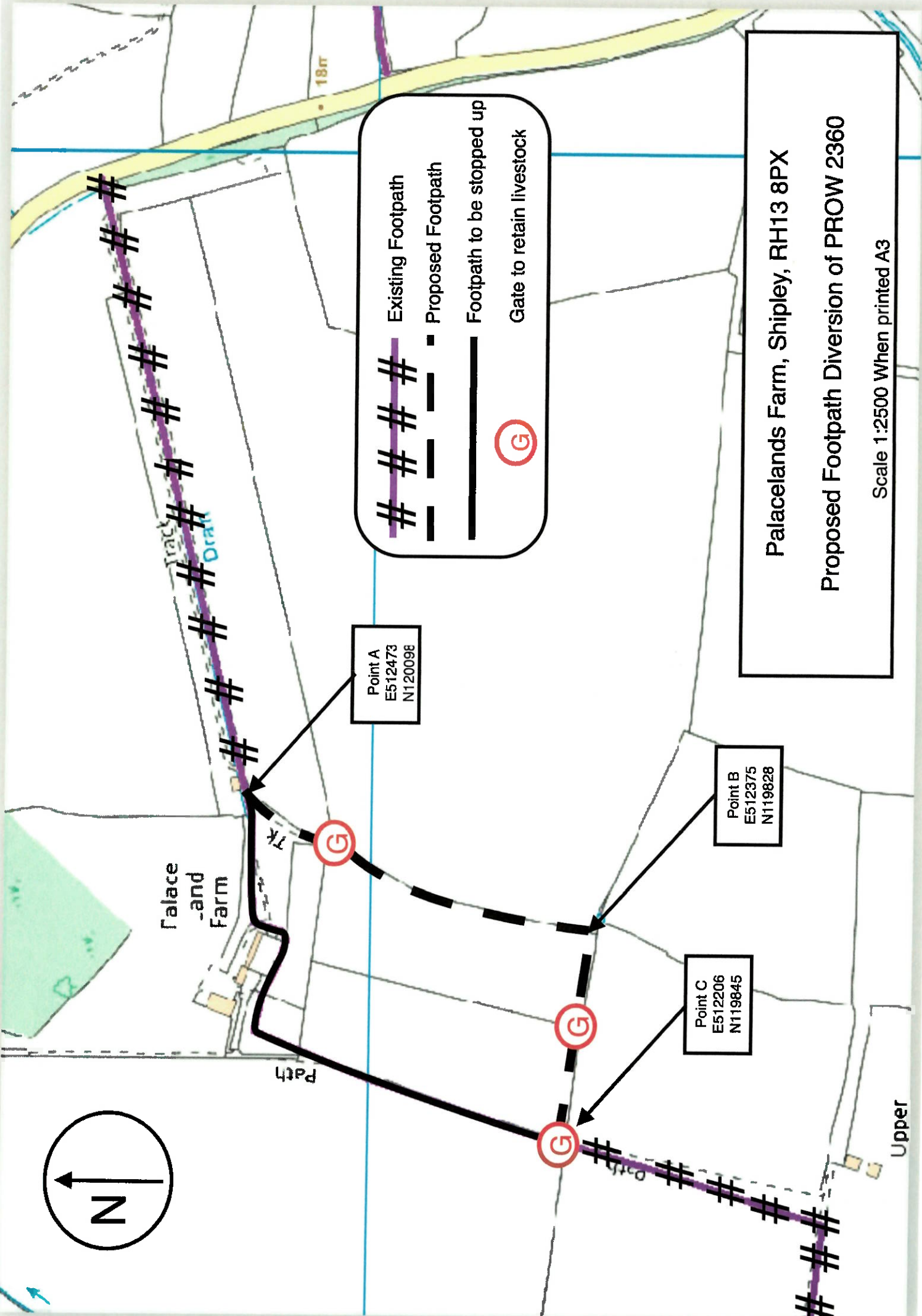
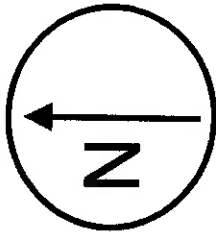

Point A  
E512473  
N120098

Point B  
E512375  
N119828

Point C  
E512206  
N119845

Existing Footpath

Proposed Footpath

Footpath to be stopped up

Gate to retain livestock

Palacelands Farm, Shipley, RH13 8PX

Proposed Footpath Diversion of PROW 2360

Scale 1:2500 When printed A3

